

19. THE CONTRACTOR SHALL RETRACE ALL CIRCUITS AND PROVIDE REVISED TYPEWRITTEN DIRECTORIES FOR THE ELECTRICAL PANELS INVOLVED IN THIS PROJECT. THE PANEL DIRECTORY SHALL REFLECT THE AS-BUILT CIRCUITS. ONE COPY OF SCHEDULE SHALL BE TAPED TO THE INSIDE OF THE PANEL. THE PANEL DIRECTORY SHALL BE SUBMITTED TO THE ENGINEER AS AN "AS-BUILT" DRAWING.
20. ELECTRICAL EQUIPMENT AND FEEDERS SHALL BE SUPPLIED AND/OR ANCHORED IN ACCORDANCE WITH UBC ZONE 4 SEISMIC REQUIREMENTS.
21. THE CONTRACTOR SHALL MAINTAIN AT THE JOB SITE, AN UP TO DATE "AS-BUILT" DRAWING SET. THE "AS-BUILT" DRAWING SET SHALL REFLECT ALL APPROVED CHANGES TO THE DESIGN DRAWINGS. THE "AS-BUILT" DRAWING SET SHALL BE KEPT CLEAN AND IN GOOD CONDITION AND SHALL BE TURNED OVER TO THE OWNER AT THE COMPLETION OF THE PROJECT.
22. UPON COMPLETION OF HIS WORK, THE CONTRACTOR SHALL SCHEDULE A DEPENDENT DEPENDENCY FUNCTIONAL TEST TO DEMONSTRATE TO THE OWNER THAT THE NEW INSULATION IS PERFORMING AS INTENDED. ANY DEFECTS OR DEFICIENCIES IN THE MATERIALS OR WORK SHALL BE CORRECTED IMMEDIATELY BY AND AT THE CONTRACTOR'S EXPENSE.
23. THE CONTRACTOR SHALL BE RESPONSIBLE FOR SECURING ALL REQUIRED ELECTRICAL PERMITS AND INSPECTIONS.

24. THE SUBMISSION OF A BID OR PROPOSAL SHALL BE CONSIDERED AS CONCLUSIVE EVIDENCE THAT THE CONTRACTOR IS THOROUGHLY FAMILIAR WITH THE INTENT OF THE CONTRACT DOCUMENT, AND NO CORRECTION OR CHANGE TO THE CONTRACT DOCUMENT, OR ANY ADDITIONAL LABORS OR MATERIAL, REQUIRED TO RECTIFY ANY DISCREPANCY DISCOVERED OR REPORTED TO THE ENGINEER AFTER THE EXECUTION OF THE CONTRACT.
25. PROVIDE 120 VOLT A/C CIRCUITS AS REQUIRED TO SERVE AUXILIARY EQUIPMENT SUCH AS HVAC BMS CONTROL PANELS, SERVICE OUTLETS FOR AIR CONDITIONING UNITS IF REQUIRED.
26. CONTRACTOR SHALL PROVIDE ANY TEST REPORTS AS PART OF TURNOVER PACKAGE TO THE OWNER.
27. CONTRACTOR SHALL PROVIDE PENETRATION FIRESTOPPINGS TO ALL NEW AND ABANDONED PENETRATIONS USING UL LISTED 3" FIRE PROTECTION PRODUCTS, ALL IN COMPLIANCE WITH 2013 CSC.
28. ELECTRICAL CONTRACTOR SHALL PROVIDE ALL BACK BOXES AND 3/4" CONDUIT SYSTEM REQUIRED BY LIFE SAFETY SYSTEM.
29. LIFE SAFETY CONTRACTOR SHALL PROVIDE A COMPLETE DESIGN AND INSTALLATION OF FIRE ALARM AND DETECTION SYSTEM. FIRE ALARM SHOP DRAWINGS SHALL BE REVIEWED AND APPROVED BY LOCAL FIRE MARSHALL PRIOR TO INSTALLATION. DESIGN SHALL BE BASED ON MANUFACTURER SYSTEM REQUIREMENTS AND STATE CODE AND REGULATIONS.

30. CONDUITS SHALL BE SUPPORTED AND BRACED THE SMACNA "GUIDELINE" FOR SEISMIC RESTRAINTS OF MECHANICAL AND PLUMBING PIPING SYSTEM OR THE SUPERSTRUT "SEISMIC RESTRAINT SYSTEM".
31. HVAC AUTOMATIC CONTROLS AND 'BMS' REFER TO MECHANICAL PLANS AND ROOF AREA PROVIDE ALL CONTROL CONDUIT REQUIRED FROM 'RM' PANEL IN MECHANICAL TO ALL SENSORS, DEVICES, CONTROLLERS, 'LOCAL' AND 'REMOTE' PHASES, COMPLETE AS SHOWN ON MECHANICAL PLANS; INCLUDING 120V-UPS POWER WIRING.
32. SECURITY SYSTEM CONDUIT AND WIRING: REFER TO SECURITY DRAWINGS FOR ALL CONDUIT, CABINETS, J-BOXES, 120V, EMERGENCY POWER AND WIRING. COMPLY WITH ALL REQUIREMENTS THEREON WHEN APPLIES. (IF AVAILABLE.)
33. ALL EXTERIOR ELECTRICAL DEVICES AND EQUIPMENT SHALL BE WEATHERPROOF TYPE, NEMA "3C".
34. BRANCH CIRCUIT WIRING CHART:
- | VOLTS | LENGTH     | WIRE SIZE | MAX. WATTS | ΔV         |
|-------|------------|-----------|------------|------------|
| 120V  | 0-100FT.   | #12       | 1250W      | 3% MAX     |
| 120V  | 101-175FT. | #10       | 1250W      | 3% MAX     |
| 277V  | 0-150FT.   | #12       | 3400W      | 2 1/2% MAX |
| 277V  | 151-250FT. | #10       | 3400W      | 2 1/2% MAX |
- NOTE: PROVIDE #10 WIRE MIN. NEUTRAL AND GROUND WIRE SIZE FOR 120 VOLT CIRCUITS.

35. CONSTRUCTION SEQUENCING AND PHASING: PROVIDE CONSTRUCTION IN PHASES AND IN CONJUNCTION WITH THE PHASING / SEQUENCING INDICATED ON THE ARCHITECTURAL PLANS AND AS REQUIRED BY THE PROJECT.
36. BACK TO BACK OUTLETS SHALL NOT BE PERMITTED IN THIS PROJECT. ALL OUTLETS MUST BE A MINIMUM OF ON STUD BAY APART WITH INSULATION SEPARATION FOR SOUND ISOLATION.

(E) PARTIAL METER MAIN SECTION

120/208V-3 $\phi$ -4W - 1600A - 65,000 MC  
W/ 600A METER SECTIONS

(E) CT

(E) 600A 3 $\phi$

(E) 200A MAIN

(E) 200A MAIN

(R) PANEL "A"

(R) PANEL "B"

CONTRACTOR TO PROVIDE AND INSTALL WARNING  
ARC FAULT WARNING LABELS FOR ALL PANELS  
AND SWITCHBOARDS AS PER CEC 11.16.

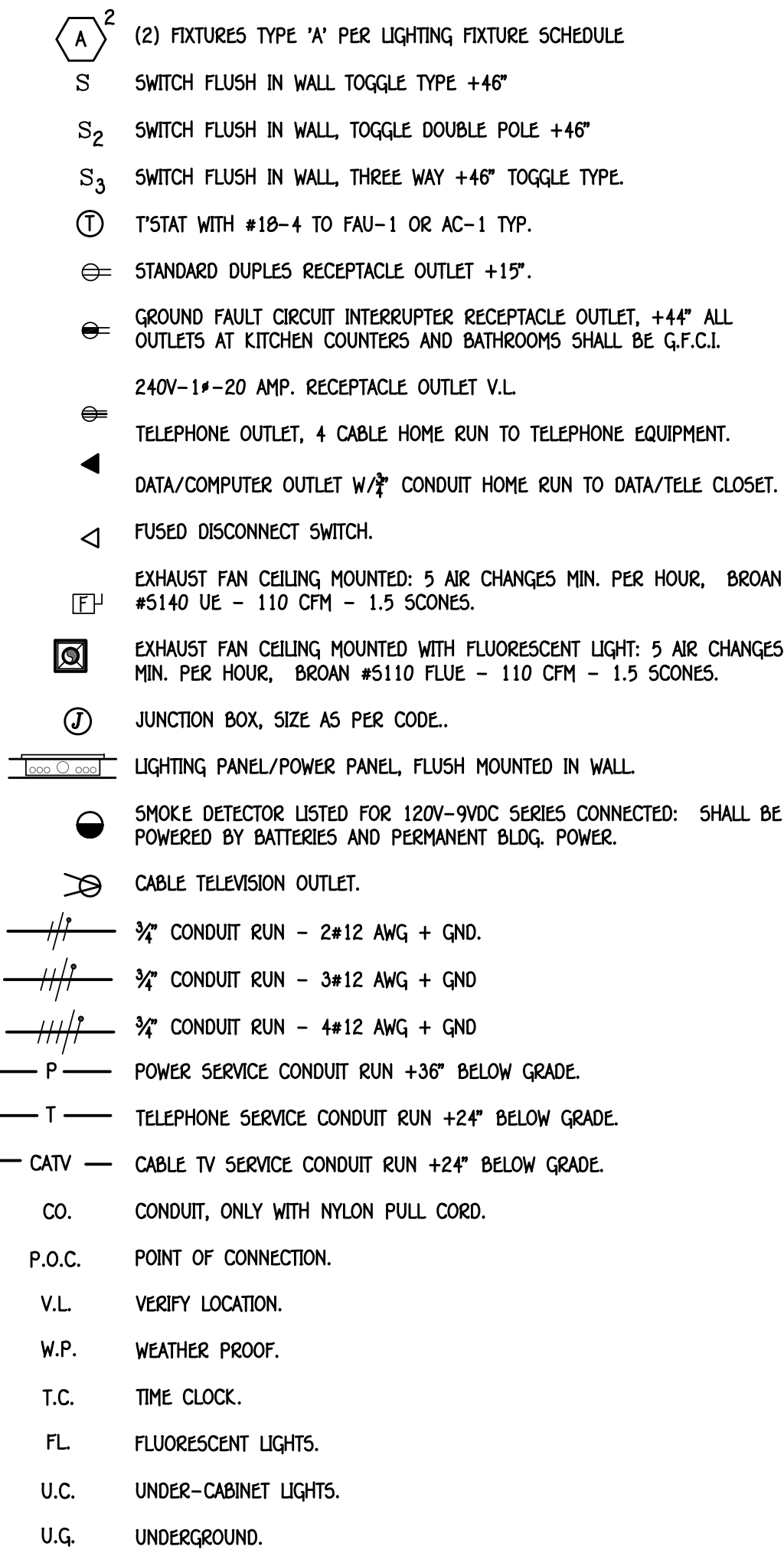

1. ALL ITEMS SHOWN ARE EXISTING, NOTES ARE FOR REFERENCE AS NEEDED.
2. FEEDER LENGTHS SHOWN ARE FOR VOLTAGE DROP & SHORT CIRCUIT CALCULATIONS ONLY.
3. ALL NEW FEEDER CONDUCTORS SHALL BE COPPER#2 AWG AND LARGER SHALL BE "XHHW"; CONDUCTORS SMALLER THAN #2 AWG SHALL BE "THHN/THWN".
4. MAXIMUM ALLOWABLE FAULT CURRENT AT MAIN SERVICE ENTRANCE IS 65 KA.
5. IN MAIN SWITCHBOARD BUS BRACING AND A.I.C. RATING OF ALL DEVICES SHALL BE 65,000 MVA.
6. ALL #1200V PANELS BOARDS ARE FULLY CONNECTED FOR THE 65,000 AIC PANELS SHALL BE LEGIBLY MARKED IN THE FIELD IN ADDITION TO THE MANUFACTURERS MARKINGS FOR FULLY COMBINATION RATING, THE MARKING SHALL BE READILY VISIBLE, DURABLE AND STATE "CAUTION-FULLY RATED SYSTEM"
7. CIRCUIT BREAKERS IN ALL MAIN SWITCHBOARDS AND 1200V<sup>1200V</sup> PANELS SHALL BE FROM THE SAME MANUFACTURER AND ENTIRE SYSTEM SHALL BE LISTED AS FULLY RATED SYSTEM FOR 65,000 AIC.
8. ALL REMAINING SPACES IN MAIN SWITCHBOARDS AND PANEL BOARDS SHALL BE BUSSED.
9. ALL 1200V<sup>1200V</sup> PANELS SHALL BE RATED 65,000 AIC U.O.N.
10. WHENEVER TWO OR MORE CIRCUIT BREAKERS OCCURE IN COMMON PANELS, MULTI-POLE BREAKER SHALL HAVE A LISTING TYPE "QUICKLACK" TYPE UNITS. SINGLE POLE BREAKERS WITH TIE-BAR BETWEEN HANDLES WILL NOT BE ACCEPTABLE.
11. PROVIDE BLACK ON WHITE LAMINATED PLASTIC NAMEPLATE ENGRAVED IN MIN 1/2" HIGH LETTERS, ATTACHED NAMEPLATES TO EQUIPMENT. SWITCHBOARD(S), DISTRIBUTION BOARD(S), PANEL BOARDS AND DISCONNECTS ETC. WITH RIVETS, BOLTS OR METAL SCREWS. CEMENT ATTACHMENTS ARE NOT ACCEPTABLE.
12. TIME SWITCHES, CONTACTORS, RELAYS, ETC. SHOWN TO BE FURNISHED WITH PANEL BOARDS SHALL BE LOCATED IN BARRIEZED COMPARTMENTS BEHIND SEPARATE DOORS, MAINTAIN 2" OF SOLD TIEP BETWEEN DOORS, IF NECESSARY, INSTALL SWITCHES, CONTACTORS, RELAYS, ETC. IN WEATHERED PROTECTIVE ENCLOSURES WITH LOCKABLE DOORS. PROVIDE SCREW-ON TYPE NAMEPLATES, FULLY COMPLY WITH LATEST HANDICAP STANDARDS.

Location: Main Service						( E ) PANEL BOARD ' A '										200/208V - 3PH - 4W			200Amp. Bus.		M.L.O.		65 KAIC	
Cir. No.	Bkr		Power	Lights	Mis.	Type of Load & Location	Load	Watts			Load	Type of Load & Location	Mis.	Lights	Power	Bkr		Cir. No.						
	AMPS	POLE						L-1	L-2	L-3						POLE	AMPS							
1	20	1		29		Lights Open Office Area (South Area)	1,015		1,815		800					4	1	20	2					
3	20	1		29		Lights Open Office Area (North Area)	922			1,722	800					4	1	20	4					
5	20	1		30		Lights Small Office and Classrooms	1,050				2,250					6	1	20	6					
7	20	1	6			Classroom #2 Outlets (North/East Walls)	1,200		2,400		1,200					6	1	20	8					
9	20	1	6			Classroom #2 Outlets (South/West Walls)	1,200			2,400	1,200					6	1	20	10					
11	20	1	6			Classroom #3 Outlets (North/East Walls)	1,200				2,400					6	1	20	12					
13	20	1	6			Office #3 Outlets (North/East Walls)	1,200	2,400			1,200					6	1	20	14					
15	20	1	6			Office #4 Outlets (South/East Walls)	1,200			2,400	1,200					6	1	20	16					
17	20	1	6			Non-Haz. Lab Outlets (South/East Walls)	1,200				2,400					2	1	20	18					
19	20	1	6			Non-Haz. Lab Outlets (North/West Walls)	1,200	2,400			1,200					2	1	20	20					
21	20	1	3			Restroom Outlets	600			1,600	1,000					1	1	20	22					
23	20	1	2			Printer Outlets (Recept. Wall West Side)	1,000				2,000					1	1	20	24					
25	20	1	2			Printer Outlets (Recept. Wall North Side)	1,000	1,000											26					
27	20	1	2			Printer Outlets (Recept. Wall East Side)	1,000			1,000									28					
29	20	1	2			Storage Room 1/4 Outlets	800				800								30					
31	20	1				Spare		0											32					
33	20	1				Spare				0									34					
35	20	1				Spare					0								36					
37	20	1				Spare		0											38					
39	20	1				Spare				0									40					
41	20	1				Spare					0								42					
Wattages Per Phase								10,015	9,122	9,850	Watts	28,987	Total Watts											
Total																								
Watts							Total		Phase loads in amps															
									83                      76                      82															
L.C.L. @ 1.25%:							2,987                      3,734		W										G = GROUND FAULT					
Other Load @100%:							26,000                      26,000		W										A = ARCH FAULT					
Total Demand Load:							29,734		W										W/G = WEATHER PROOF/GOUND FAULT					
120/208V - 3PH - 4W =																			83 Watts					

- \* PROVIDE AND INSTALL LOCK ON DEVICE.
- \*\* CEC 400.4(A) - EVERY CIRCUIT AND CIRCUIT MODIFICATION SHALL BE LEGIBLY IDENTIFIED AS TO ITS CLEAR, EVIDENT, AND SPECIFIC PURPOSE OR USE. EACH CIRCUIT SHALL BE DISTINGUISHED FROM ALL OTHERS.

Location: Main Service						( E ) PANEL BOARD ' B '													120/208V - 3PH - 4W			
Cir. No.	Bkr		Power	Lights	Mis.	Type of Load & Location	Load	Watts			Load	Type of Load & Location	Mis.	Lights	Power	Bkr		Cir. No.				
	AMPS	POLE						L-1	L-2	L-3						POLE	AMPS					
1	20	1	1		8"	Show Window Outlets A	1,600	3,200			1,600	Show Window Outlets G				1	1	20	2			
3	20	1	1		8"	Show Window Outlets B	1,600		3,200		1,600	Show Window Outlets H				1	1	20	4			
5	20	1	1		8"	Show Window Outlets C	1,600			3,200	1,600	Show Window Outlets I				1	1	20	6			
7	20	1	1		8"	Show Window Outlets D	1,600	3,200			1,600	Show Window Outlets J				1	1	20	8			
9	20	1	1		8"	Show Window Outlets E	1,600		3,200		1,600	Show Window Outlets K				1	1	20	10			
11	20	1	1		8"	Show Window Outlets F	1,600			3,200	1,600	Show Window Outlets L				1	1	20	12			
13	50	2			1	Electric Water Heater	4,500	6,100			1,600	Show Window Outlets M				1	1	20	14			
15						208V-1Ph-9kW	4,500		7,953		3,453	CU-1	1			2	35	16				
17	35	2			1	CU-3	3,453			6,906	3,453	208V-1Ph-33.2A				2	35	18				
19						208V-1Ph-33.2A	3,453	6,906			3,453	CU-2	1			2	35	20				
21	35	2			1	CU-4	3,453		6,906		3,453	208V-1Ph-33.2A						22				
23						208V-1Ph-33.2A	3,453			4,253	800	Roof Top Power Outlets				4	1	20	24			
25	20	1				O.S.A. Exhaust Fan	189	189				Space				1	20	26				
27	20	1				Space			0			Space				1	20	28				
29	20	1				Space				0		Space				1	20	30				
31	20	1				Space		0				Space				1	20	32				
33	20	1				Space			0			Space				1	20	34				
35	20	1				Space				0		Space				1	20	36				
37	20	1				Space		0				Space				1	20	38				
39	20	1				Space			0			Space				1	20	40				
41	20	1				Space				0		Space				1	20	42				
Wattages Per Phase							19,595	21,258	17,558	Watts	58,411											
Total							Total Watts															
							Phase loads in amps															
							163	177	146													
L.C.L. @ 1.25%:							6,100	7,625	W	G = GROUND FAULT												
Other Load @ 100%:							52,311	52,311	W	A = ARCH FAULT												
Total Demand Load:							59,936	W	W/G = WEATHER PROOF/GOUND FAULT													
120/208V - 3PH - 4W = 166 Watts																						

- \*\* CEC 408.4(A) - EVERY CIRCUIT AND CIRCUIT MODIFICATION SHALL BE LEGIBLY IDENTIFIED AS TO ITS CLEAR, EVIDENT, AND SPECIFIC PURPOSE OR USE. EACH CIRCUIT SHALL BE DISTINGUISHED FROM ALL OTHERS.



**DARRYL MURRAY INC.**  
MURRAY ENGINEERING & DESIGN  
**MECHANICAL • ELECTRICAL • PLUMBING**  
1355 N. 3775 W., Cedar City, UT 84721  
Tel: 818.355.0225 Fax: -  
darryl@murrayengineer.com

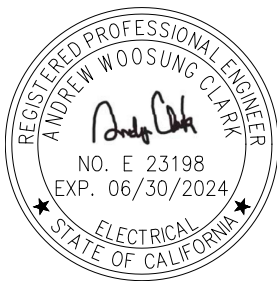

# Options For Youth

Address: 131 N. AZUSA AVE.  
WEST COVINA, CA 91791

These drawings/specifications are the property of Darryl Murray Inc. They are furnished as contract documents only. The seal(s) and signature(s) apply only to the documents to which they affixed, and expressly disclaim any responsibility for all other plans, specifications, estimates, reports or other documents or instruments relating to or intended to be used for any part or parts of the architectural or engineering project. Additionally these drawings and seal(s) shall in no way convey or imply any time of warranty or certification relating to the performance of products and materials beyond those provided by their respective manufacturer.

[illegible]

## E1.0





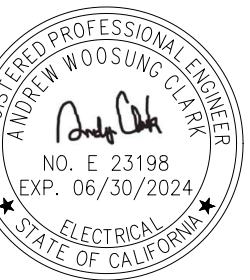
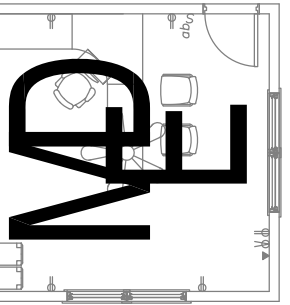

Address: 131 N. AZUSA AVE.  
WEST COVINA, CA 91791

These drawings/specifications are the property of Darryl Murray Inc. They are furnished as contract documents only. The seal(s) and signature(s) apply only to the documents to which they affixed, and expressly disclaim any responsibility for all other plans, specifications, estimates, reports or other documents or instruments relating to or intended to be used for any part or parts of the architectural or engineering project. Additionally these drawings and seal(s) shall in no way convey or imply any time of warranty or certification relating to the performance of products and materials beyond those provided by their respective manufacturer.

ISSUE:	
DATE	DESCRIPTION
04/03/23	1 <sup>ST</sup> PLAN CHECK CORR.

[illegible]

Drawn / Reviewed: DM/RG/AC
Issue Date 01/24/23
Sheet Name  ELECTRICAL POWER PLAN

Sheet Number

## E3.0

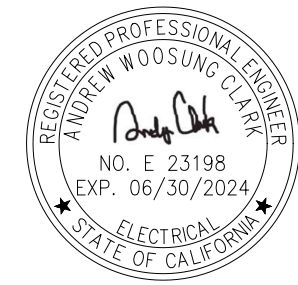
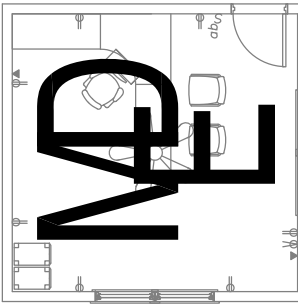

Options For Youth

Address: 131 N. AZUSA AVE.  
WEST COVINA, CA 91791

These drawings/specifications are the property of Darryl Murray Inc. They are furnished as contract documents only. The seal(s) and signature(s) apply only to the documents to which they affixed, and expressly disclaim any responsibility for all other plans, specifications, estimates, reports or other documents or instruments relating to or intended to be used for any part or parts of the architectural or engineering project. Additionally these drawings and seal(s) shall in no way convey or imply any time of warranty or certification relating to the performance of products and materials beyond those provided by their respective manufacturer.

ISSUE:	
DATE	DESCRIPTION
04/03/23	1 <sup>st</sup> PLAN CHECK CORR.

Drawn / Reviewed:  
DM/RG/AC

Issue Date  
01/24/23

Sheet Name  
ELECTRICAL  
ROOF PLAN

Sheet Number

E4.0



STATE OF CALIFORNIA

Indoor Lighting

CALIFORNIA ENERGY COMMISSION

CERTIFICATE OF COMPLIANCE

NRCC-LTI-E

Project Name:

Opportunities For Learning

Report Page:

(Page 1 of 7)

Project Address:

131 N. Azusa Ave

Date Prepared:

4/3/2023

A. GENERAL INFORMATION

01

Project Location (city)

West Covina

02

Climate Zone

9

03

Occupancy Types Within Project (select all that apply):

Classroom • Office • Support Areas • All Other Occupancies

04

Total Conditioned Floor Area (ft²)

4,574

05

Total Unconditioned Floor Area (ft²)

0

06

# of Stories (Habitable Above Grade)

1

B. PROJECT SCOPE

This table includes any lighting systems that are within the scope of the permit application and are demonstrating compliance using the prescriptive path outlined in 140.6 / 170.2(e) or 141.0(b)2 / 180.2(b)4 for alterations.

Scope of Work

Conditioned Spaces

Unconditioned Spaces

01

My Project Consists of (check all that apply):

☐ New Lighting System

☐ New Lighting System - Parking Garage

☒ Altered Lighting System

Total Area of Work (ft²)

4574

0

02

Calculation Method

03

Area (ft²)

04

Calculation Method

05

Area (ft²)

Registration Number:

Generated Date/Time:

Documentation Software: EnergyPro

CA Building Energy Efficiency Standards - 2022 Nonresidential Compliance

Report Version: 2022.0.000

Schema Version: rev 20220101

Compliance ID: EnergyPro-7303-0423-0255

Report Generated: 2023-04-03 00:06:01

STATE OF CALIFORNIA

Indoor Lighting

CALIFORNIA ENERGY COMMISSION

CERTIFICATE OF COMPLIANCE

NRCC-LTI-E

Project Name:

Opportunities For Learning

Report Page:

(Page 4 of 7)

Project Address:

131 N. Azusa Ave

Date Prepared:

4/3/2023

H. INDOOR LIGHTING CONTROLS (Not including PAFs)

Area Level Controls

04

Area Description

Complete Building or Area Category Primary Function Area

05

Manual Area Controls

130.1(a) / 160.5(b)4A

06

Multi-Level Controls

130.1(b) / 160.5(b)4B

07

Shut-Off Controls

130.1(c) // 160.5(b)4C

08

Primary/Sky lit Daylighting

130.1(d) / 160.5(b)4D

09

Secondary Daylighting

140.5(a) / 170.2(e)2A

10

Interlocked Systems

140.5(a) / 170.2(e)2A

11

Field Inspector

Pass

Fail

12

Plan Sheet Showing Daylit Zones:

I. LIGHTING POWER ALLOWANCE: COMPLETE BUILDING OR AREA CATEGORY METHODS

Each area complying using the Complete Building or Area Category Methods per 140.6(b) are included in this table. Column 06 indicates if additional lighting power allowances per 140.6(c) or adjustments per 140.6(a) are being used.

Conditioned Spaces

01

Area Description

Lobby

02

Complete Building or Area Category Primary Function Area

All Other Space Types

03

Allowed Density (W/ft²)

0.7

04

Area (ft²)

165

05

Allowed Wattage (Watts)

115.5

06

Additional Allowance / Adjustment

Area Category

PAF

01

Open Reading

Classroom, Lecture, or Training Vocational

0.6

634

380.4

No

No

02

Offices

Office (<=250 square feet)

0.65

569

369.8

No

No

03

Classrooms

Classroom, Lecture, or Training Vocational

0.6

1,791

1,074.6

No

No

04

Storage

All Other Space Types

0.4

360

144

No

No

05

Corridor

Corridor

0.4

726

290.4

No

No

06

Restroom

Restroom

0.65

209

135.8

No

No

07

Breakroom

Lounge

0.55

120

66

No

No

TOTALS:

4,574

2,576.5

See Tables J, or P for detail

Registration Number:

Generated Date/Time:

Documentation Software: EnergyPro

CA Building Energy Efficiency Standards - 2022 Nonresidential Compliance

Report Version: 2022.0.000

Schema Version: rev 20220101

Compliance ID: EnergyPro-7303-0423-0255

Report Generated: 2023-04-03 00:06:01

STATE OF CALIFORNIA

Indoor Lighting

CALIFORNIA ENERGY COMMISSION

CERTIFICATE OF COMPLIANCE

NRCC-LTI-E

Project Name:

Opportunities For Learning

Report Page:

(Page 7 of 7)

Project Address:

131 N. Azusa Ave

Date Prepared:

4/3/2023

DOCUMENTATION AUTHOR'S DECLARATION STATEMENT

I certify that this Certificate of Compliance documentation is accurate and complete.

Documentation Author Name:

Darryl Murray

Company:

Darryl Murray Inc.

Address:

1355 N. 3775 W

City/State/Zip:

Cedar City UT 4721

Documentation Author's Signature:

Signature Date:

CEA/HERS Certification Identification (if applicable):

Phone:

818-355-0225

RESPONSIBLE PERSON'S DECLARATION STATEMENT

I certify the following under penalty of perjury, under the laws of the State of California:

1. The information provided on this Certificate of Compliance is true and correct.

2. I am eligible under Division 5 of the Business and Professions Code to accept responsibility for the building design or system design identified on this Certificate of Compliance (responsible designer).

3. The energy features and performance specifications, materials, components, and manufactured devices for the building design or system design identified on the Certificate of Compliance conform to the requirements of Title 24, Part 1 and Part 6 of the California Code of Regulations.

4. The building design features or system design features identified on this Certificate of Compliance are consistent with the information provided on other applicable compliance documents, worksheets, calculations, plans and specifications submitted to the enforcement agency for approval with this building permit application.

5. I will ensure that a completed signed copy of this Certificate of Compliance shall be made available with the building permit(s) issued for the building, and made available to the enforcement agency for all applicable inspections. I understand that a completed signed copy of this Certificate of Compliance is required to be included with the documentation the builder provides to the building owner at occupancy.

Responsible Designer Name:

Andrew Clark

Company:

Darryl Murray Inc.

Address:

1355 N. 3775 W

City/State/Zip:

Cedar City UT 84721

Responsible Designer's Signature:

Date Signed:

2/23-04-C3

License:

23198

Phone:

818-355-0225

Registration Number:

Generated Date/Time:

Documentation Software: EnergyPro

CA Building Energy Efficiency Standards - 2022 Nonresidential Compliance

Report Version: 2022.0.000

Schema Version: rev 20220101

Compliance ID: EnergyPro-7303-0423-0255

Report Generated: 2023-04-03 00:06:01

STATE OF CALIFORNIA

Indoor Lighting

CALIFORNIA ENERGY COMMISSION

CERTIFICATE OF COMPLIANCE

NRCC-LTI-E

Project Name:

Opportunities For Learning

Report Page:

(Page 2 of 7)

Project Address:

131 N. Azusa Ave

Date Prepared:

4/3/2023

C. COMPLIANCE RESULTS

If any call on this table says "DOES NOT COMPLY" or "COMPLIES with Exceptional Conditions" refer to Table D, for guidance.

Lighting in conditioned and unconditioned spaces must not be combined for compliance per 140.6(b)1 / 170.2(e)

01

Complete Building

140.6(c)1

02

Area Category

140.6(c)2 / 170.2(e)4

03

Area Category Additional

140.6(c)3 / 170.2(e)4Av

04

Tailored

140.6(c)3 / 170.2(e)4B

05

Total Allowed (Watts)

=

06

Total Designed (Watts)

2,561

07

PAF Lighting Control Credits

140.6(a)2 / 170.2(e)1B (-)

08

Total Adjusted (Watts)

=

09

Compliance Results

05 must be >= 08 140.6 / 170.2(e)

Conditioned

Unconditioned

Controls Compliance (See Table H for Details)

Rated Power Reduction Compliance (See Table Q for Details)

D. EXCEPTIONAL CONDITIONS

This table is auto-filled with uneditable comments because of selections made or data entered in tables throughout the form.

E. ADDITIONAL REMARKS

This table includes remarks made by the permit applicant to the Authority Having Jurisdiction.

Registration Number:

Generated Date/Time:

Documentation Software: EnergyPro

CA Building Energy Efficiency Standards - 2022 Nonresidential Compliance

Report Version: 2022.0.000

Schema Version: rev 20220101

Compliance ID: EnergyPro-7303-0423-0255

Report Generated: 2023-04-03 00:06:01

STATE OF CALIFORNIA

Indoor Lighting

CALIFORNIA ENERGY COMMISSION

CERTIFICATE OF COMPLIANCE

NRCC-LTI-E

Project Name:

Opportunities For Learning

Report Page:

(Page 6 of 7)

Project Address:

131 N. Azusa Ave

Date Prepared:

4/3/2023

J. ADDITIONAL ALLOWANCE: AREA CATEGORY METHOD QUALIFYING LIGHTING SYSTEM

This section does not apply to this project.

K. TAILORED METHOD GENERAL LIGHTING POWER ALLOWANCE

This section does not apply to this project.

L. ADDITIONAL LIGHTING ALLOWANCE: TAILORED WALL DISPLAY

This section does not apply to this project.

M. ADDITIONAL LIGHTING ALLOWANCE: TAILORED FLOOR AND TASK LIGHTING

This section does not apply to this project.

N. ADDITIONAL LIGHTING ALLOWANCE: TAILORED DECORATIVE /SPECIAL EFFECTS

This section does not apply to this project.

O. ADDITIONAL LIGHTING ALLOWANCE: TAILORED VERY VALUABLE MERCHANDISE

This section does not apply to this project.

P. POWER ADJUSTMENT: LIGHTING CONTROL CREDIT (POWER ADJUSTMENT FACTOR (PAF))

This section does not apply to this project.

Q. RATED POWER REDUCTION COMPLIANCE FOR ONE-FOR-ONE ALTERATIONS

This section does not apply to this project.

Registration Number:

Generated Date/Time:

Documentation Software: EnergyPro

CA Building Energy Efficiency Standards - 2022 Nonresidential Compliance

Report Version: 2022.0.000

Schema Version: rev 20220101

Compliance ID: EnergyPro-7303-0423-0255

Report Generated: 2023-04-03 00:06:01

STATE OF CALIFORNIA

Indoor Lighting

CALIFORNIA ENERGY COMMISSION

CERTIFICATE OF COMPLIANCE

NRCC-LTI-E

Project Name:

Opportunities For Learning

Report Page:

(Page 3 of 7)

Project Address:

131 N. Azusa Ave

Date Prepared:

4/3/2023

F. INDOOR LIGHTING FIXTURE SCHEDULE

This table includes all planned permanent and portable lighting other than dwelling unit/ hotel/ motel room lighting. Multifamily dwelling unit and hotel/motel room lighting is documented in Table I. If using Table T to document lighting in multifamily common use areas providing shared provisions for living, eating, cooking or sanitation, those luminaires are not included here.

Designed Wattage: Conditioned Spaces

01

Name or Item Tag

A/AE

02

Complete Luminaire Description

LED 2x4 Fixture

03

Modular (Track) Fixture

No

04

Small Aperture & Color Change¹

NA

05

Watts per luminaire¹

29

06

How is Wattage determined

Mfr. Spec

07

Total Number of Luminaires

85

08

Excluded per 140.6(a)3 / 170.2(e)2C

No

09

Design Watts

2,465

10

Field Inspector

Pass

Fail

01

B

LED 1x4 Fixture

No

NA

32

Mfr. Spec

3

No

96

COMPLIES

Total Designed Watts: CONDITIONED SPACES

2,561

¹FOOTNOTE: Design Watts for small aperture and color changing luminaires which qualify per 140.6(a)4B / 170.2(e)2D is adjusted to be 75%/80% of their rated wattage. Table F automatically makes this adjustment, the permit applicant should enter full rated wattage in column 05.

²Authority Having Jurisdiction may ask for Luminaire cut sheets to confirm wattage used for compliance per 130.0(c) / 160.5(b). Wattage used must be the maximum rated for the luminaire, not the lamp.

G. MODULAR LIGHTING SYSTEMS

This section does not apply to this project.

H. INDOOR LIGHTING CONTROLS (Not including PAFs)

This table includes lighting controls for conditioned and unconditioned spaces.

Building Level Controls

01

Mandatory Demand Response 110.12(c)

02

Shut-off controls 130.1(c) / 160.5(b)4C

03

Field Inspector

Pass

Fail

Required >= 4,000W subject to multilevel

Whole Building Auto Time Switch

☐

☐

Registration Number:

Generated Date/Time:

Documentation Software: EnergyPro

CA Building Energy Efficiency Standards - 2022 Nonresidential Compliance

Report Version: 2022.0.000

Schema Version: rev 20220101

Compliance ID: EnergyPro-7303-0423-0255

Report Generated: 2023-04-03 00:06:01

STATE OF CALIFORNIA

Indoor Lighting

CALIFORNIA ENERGY COMMISSION

CERTIFICATE OF COMPLIANCE

NRCC-LTI-E

Project Name:

Opportunities For Learning

Report Page:

(Page 5 of 7)

Project Address:

131 N. Azusa Ave

Date Prepared:

4/3/2023

R. 80% LIGHTING POWER FOR ALL ALTERATIONS - CONTROLS EXCEPTIONS

This section does not apply to this project.

S. DAYLIGHT DESIGN POWER ADJUSTMENT FACTOR (PAF)

This section does not apply to this project.

T. DWELLING UNIT LIGHTING

This section does not apply to this project.

U. DECLARATION OF REQUIRED CERTIFICATES OF INSTALLATION

Form/Title

NRCH-LTI-E - Must be submitted for all buildings

V. DECLARATION OF REQUIRED CERTIFICATES OF ACCEPTANCE

Form/Title

Systems/Spaces To Be Field Verified

NRCA-LTI-02-A - Must be submitted for occupancy sensors and automatic time switch controls.

Whole Building Time Switch;

NRCA-LTI-04-A - Must be submitted for demand responsive lighting controls.

Whole Building Demand Response;

Registration Number:

Generated Date/Time:

Documentation Software: EnergyPro

CA Building Energy Efficiency Standards - 2022 Nonresidential Compliance

Report Version: 2022.0.000

Schema Version: rev 20220101

Compliance ID: EnergyPro-7303-0423-0255

Report Generated: 2023-04-03 00:06:01

STATE OF CALIFORNIA

Indoor Lighting

CALIFORNIA ENERGY COMMISSION

CERTIFICATE OF COMPLIANCE

NRCC-LTI-E

Project Name:

Opportunities For Learning

Report Page:

(Page 7 of 7)

Project Address:

131 N. Azusa Ave

Date Prepared:

4/3/2023

DOCUMENTATION AUTHOR'S DECLARATION STATEMENT

I certify that this Certificate of Compliance documentation is accurate and complete.

Documentation Author Name:

Darryl Murray

Company:

Darryl Murray Inc.

Address:

1355 N. 3775 W

City/State/Zip:

Cedar City UT 4721

Documentation Author's Signature:

Signature Date:

CEA/HERS Certification Identification (if applicable):

Phone:

818-355-0225

RESPONSIBLE PERSON'S DECLARATION STATEMENT

I certify the following under penalty of perjury, under the laws of the State of California:

1. The information provided on this Certificate of Compliance is true and correct.

2. I am eligible under Division 5 of the Business and Professions Code to accept responsibility for the building design or system design identified on this Certificate of Compliance (responsible designer).

3. The energy features and performance specifications, materials, components, and manufactured devices for the building design or system design identified on the Certificate of Compliance conform to the requirements of Title 24, Part 1 and Part 6 of the California Code of Regulations.

4. The building design features or system design features identified on this Certificate of Compliance are consistent with the information provided on other applicable compliance documents, worksheets, calculations, plans and specifications submitted to the enforcement agency for approval with this building permit application.

5. I will ensure that a completed signed copy of this Certificate of Compliance shall be made available with the building permit(s) issued for the building, and made available to the enforcement agency for all applicable inspections. I understand that a completed signed copy of this Certificate of Compliance is required to be included with the documentation the builder provides to the building owner at occupancy.

Responsible Designer Name:

Andrew Clark

Company:

Darryl Murray Inc.

Address:

1355 N. 3775 W

City/State/Zip:

Cedar City UT 84721

Responsible Designer's Signature:

Date Signed:

2/23-04-C3

License:

23198

Phone:

818-355-0225

Registration Number:

Generated Date/Time:

Documentation Software: EnergyPro

CA Building Energy Efficiency Standards - 2022 Nonresidential Compliance

Report Version: 2022.0.000

Schema Version: rev 20220101

Compliance ID: EnergyPro-7303-0423-0255

Report Generated: 2023-04-03 00:06:01

STATE OF CALIFORNIA

Indoor Lighting

CALIFORNIA ENERGY COMMISSION

CERTIFICATE OF COMPLIANCE

NRCC-LTI-E

Project Name:

Opportunities For Learning

Report Page:

(Page 3 of 7)

Project Address:

131 N. Azusa Ave

Date Prepared:

4/3/2023

F. INDOOR LIGHTING FIXTURE SCHEDULE

This table includes all planned permanent and portable lighting other than dwelling unit/ hotel/ motel room lighting. Multifamily dwelling unit and hotel/motel room lighting is documented in Table I. If using Table T to document lighting in multifamily common use areas providing shared provisions for living, eating, cooking or sanitation, those luminaires are not included here.

Designed Wattage: Conditioned Spaces

01

Name or Item Tag

A/AE

02

Complete Luminaire Description

LED 2x4 Fixture

03

Modular (Track) Fixture

No

04

Small Aperture & Color Change¹

NA

05

Watts per luminaire¹

29

06

How is Wattage determined

Mfr. Spec

07

Total Number of Luminaires

85

08

Excluded per 140.6(a)3 / 170.2(e)2C

No

09

Design Watts

2,465

10

Field Inspector

Pass

Fail

01

B

LED 1x4 Fixture

No

NA

32

Mfr. Spec

3

No

96

COMPLIES

Total Designed Watts: CONDITIONED SPACES

2,561

¹FOOTNOTE: Design Watts for small aperture and color changing luminaires which qualify per 140.6(a)4B / 170.2(e)2D is adjusted to be 75%/80% of their rated wattage. Table F automatically makes this adjustment, the permit applicant should enter full rated wattage in column 05.

²Authority Having Jurisdiction may ask for Luminaire cut sheets to confirm wattage used for compliance per 130.0(c) / 160.5(b). Wattage used must be the maximum rated for the luminaire, not the lamp.

G. MODULAR LIGHTING SYSTEMS

This section does not apply to this project.

H. INDOOR LIGHTING CONTROLS (Not including PAFs)

This table includes lighting controls for conditioned and unconditioned spaces.

Building Level Controls

01

Mandatory Demand Response 110.12(c)

02

Shut-off controls 130.1(c) / 160.5(b)4C

03

Field Inspector

Pass

Fail

Required >= 4,000W subject to multilevel

Whole Building Auto Time Switch

☐

☐

Registration Number:

Generated Date/Time:

Documentation Software: EnergyPro

CA Building Energy Efficiency Standards - 2022 Nonresidential Compliance

Report Version: 2022.0.000

Schema Version: rev 20220101

Compliance ID: EnergyPro-7303-0423-0255

Report Generated: 2023-04-03 00:06:01

STATE OF CALIFORNIA

Indoor Lighting

CALIFORNIA ENERGY COMMISSION

CERTIFICATE OF COMPLIANCE

NRCC-LTI-E

Project Name:

Opportunities For Learning

Report Page:

(Page 6 of 7)

Project Address:

131 N. Azusa Ave

Date Prepared:

4/3/2023

R. 80% LIGHTING POWER FOR ALL ALTERATIONS - CONTROLS EXCEPTIONS

This section does not apply to this project.

S. DAYLIGHT DESIGN POWER ADJUSTMENT FACTOR (PAF)

This section does not apply to this project.

T. DWELLING UNIT LIGHTING

This section does not apply to this project.

U. DECLARATION OF REQUIRED CERTIFICATES OF INSTALLATION

Form/Title

NRCH-LTI-E - Must be submitted for all buildings

V. DECLARATION OF REQUIRED CERTIFICATES OF ACCEPTANCE

Form/Title

Systems/Spaces To Be Field Verified

NRCA-LTI-02-A - Must be submitted for occupancy sensors and automatic time switch controls.

Whole Building Time Switch;

NRCA-LTI-04-A - Must be submitted for demand responsive lighting controls.

Whole Building Demand Response;

Registration Number:

Generated Date/Time:

Documentation Software: EnergyPro

CA Building Energy Efficiency Standards - 2022 Nonresidential Compliance

Report Version: 2022.0.000

Schema Version: rev 20220101

Compliance ID: EnergyPro-7303-0423-0255

Report Generated: 2023-04-03 00:06:01

STATE OF CALIFORNIA

Indoor Lighting

CALIFORNIA ENERGY COMMISSION

CERTIFICATE OF COMPLIANCE

NRCC-LTI-E

Project Name:

Opportunities For Learning

Report Page:

(Page 7 of 7)

Project Address:

131 N. Azusa Ave

Date Prepared:

4/3/2023

DOCUMENTATION AUTHOR'S DECLARATION STATEMENT

I certify that this Certificate of Compliance documentation is accurate and complete.

Documentation Author Name:

Darryl Murray

Company:

Darryl Murray Inc.

Address:

1355 N. 3775 W

City/State/Zip:

Cedar City UT 4721

Documentation Author's Signature:

Signature Date:

CEA/HERS Certification Identification (if applicable):

Phone:

818-355-0225

RESPONSIBLE PERSON'S DECLARATION STATEMENT

I certify the following under penalty of perjury, under the laws of the State of California:

1. The information provided on this Certificate of Compliance is true and correct.

2. I am eligible under Division 5 of the Business and Professions Code to accept responsibility for the building design or system design identified on this Certificate of Compliance (responsible designer).

3. The energy features and performance specifications, materials, components, and manufactured devices for the building design or system design identified on the Certificate of Compliance conform to the requirements of Title 24, Part 1 and Part 6 of the California Code of Regulations.

4. The building design features or system design features identified on this Certificate of Compliance are consistent with the information provided on other applicable compliance documents, worksheets, calculations, plans and specifications submitted to the enforcement agency for approval with this building permit application.

5. I will ensure that a completed signed copy of this Certificate of Compliance shall be made available with the building permit(s) issued for the building, and made available to the enforcement agency for all applicable inspections. I understand that a completed signed copy of this Certificate of Compliance is required to be included with the documentation the builder provides to the building owner at occupancy.

Responsible Designer Name:

Andrew Clark

Company:

Darryl Murray Inc.

Address:

1355 N. 3775 W

City/State/Zip:

Cedar City UT 84721

Responsible Designer's Signature:

Date Signed:

2/23-04-C3

License:

23198

Phone:

818-355-0225

Registration Number:

Generated Date/Time:

Documentation Software: EnergyPro

CA Building Energy Efficiency Standards - 2022 Nonresidential Compliance

Report Version: 2022.0.000

Schema Version: rev 20220101

Compliance ID: EnergyPro-7303-0423-0255

Report Generated: 2023-04-03 00:06:01

STATE OF CALIFORNIA

Indoor Lighting

CALIFORNIA ENERGY COMMISSION

CERTIFICATE OF COMPLIANCE

NRCC-LTI-E

Project Name:

Opportunities For Learning

Report Page:

(Page 2 of 7)

Project Address:

131 N. Azusa Ave

Date Prepared:

4/3/2023

C. COMPLIANCE RESULTS

If any call on this table says "DOES NOT COMPLY" or "COMPLIES with Exceptional Conditions" refer to Table D, for guidance.

Lighting in conditioned and unconditioned spaces must not be combined for compliance per 140.6(b)1 / 170.2(e)

01

Complete Building

140.6(c)1

02

Area Category

140.6(c)2 / 170.2(e)4

03

Area Category Additional

140.6(c)3 / 170.2(e)4Av

04

Tailored

140.6(c)3 / 170.2(e)4B

05

Total Allowed (Watts)

=

06

Total Designed (Watts)

2,561

07

PAF Lighting Control Credits

140.6(a)2 / 170.2(e)1B (-)

08

Total Adjusted (Watts)

=

09

Compliance Results

05 must be >= 08 140.6 / 170.2(e)

Conditioned

Unconditioned

Controls Compliance (See Table H for Details)

Rated Power Reduction Compliance (See Table Q for Details)

D. EXCEPTIONAL CONDITIONS

This table is auto-filled with uneditable comments because of selections made or data entered in tables throughout the form.

E. ADDITIONAL REMARKS

This table includes remarks made by the permit applicant to the Authority Having Jurisdiction.

Registration Number:

Generated Date/Time:

Documentation Software: EnergyPro

CA Building Energy Efficiency Standards - 2022 Nonresidential Compliance

Report Version: 2022.0.000

Schema Version: rev 20220101

Compliance ID: EnergyPro-7303-0423-0255

Report Generated: 2023-04-03 00:06:01

STATE OF CALIFORNIA

Indoor Lighting

CALIFORNIA ENERGY COMMISSION

CERTIFICATE OF COMPLIANCE

NRCC-LTI-E

Project Name:

Opportunities For Learning

Report Page:

(Page 6 of 7)

Project Address:

131 N. Azusa Ave

Date Prepared:

4/3/2023

J. ADDITIONAL ALLOWANCE: AREA CATEGORY METHOD QUALIFYING LIGHTING SYSTEM

This section does not apply to this project.

K. TAILORED METHOD GENERAL LIGHTING POWER ALLOWANCE

This section does not apply to this project.

L. ADDITIONAL LIGHTING ALLOWANCE: TAILORED WALL DISPLAY

This section does not apply to this project.

M. ADDITIONAL LIGHTING ALLOWANCE: TAILORED FLOOR AND TASK LIGHTING

This section does not apply to this project.

N. ADDITIONAL LIGHTING ALLOWANCE: TAILORED DECORATIVE /SPECIAL EFFECTS

This section does not apply to this project.

O. ADDITIONAL LIGHTING ALLOWANCE: TAILORED VERY VALUABLE MERCHANDISE

This section does not apply to this project.

P. POWER ADJUSTMENT: LIGHTING CONTROL CREDIT (POWER ADJUSTMENT FACTOR (PAF))

This section does not apply to this project.

Q. RATED POWER REDUCTION COMPLIANCE FOR ONE-FOR-ONE ALTERATIONS

This section does not apply to this project.

Registration Number:

Generated Date/Time:

Documentation Software: EnergyPro

CA Building Energy Efficiency Standards - 2022 Nonresidential Compliance

Report Version: 2022.0.000

Schema Version: rev 20220101

Compliance ID: EnergyPro-7303-0423-0255

Report Generated: 2023-04-03 00:06:01

STATE OF CALIFORNIA

Indoor Lighting

CALIFORNIA ENERGY COMMISSION

CERTIFICATE OF COMPLIANCE

NRCC-LTI-E